

VariDesk® Premier Electric Single-Monitor and Dual-Monitor

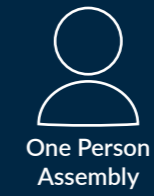

COMPONENTS

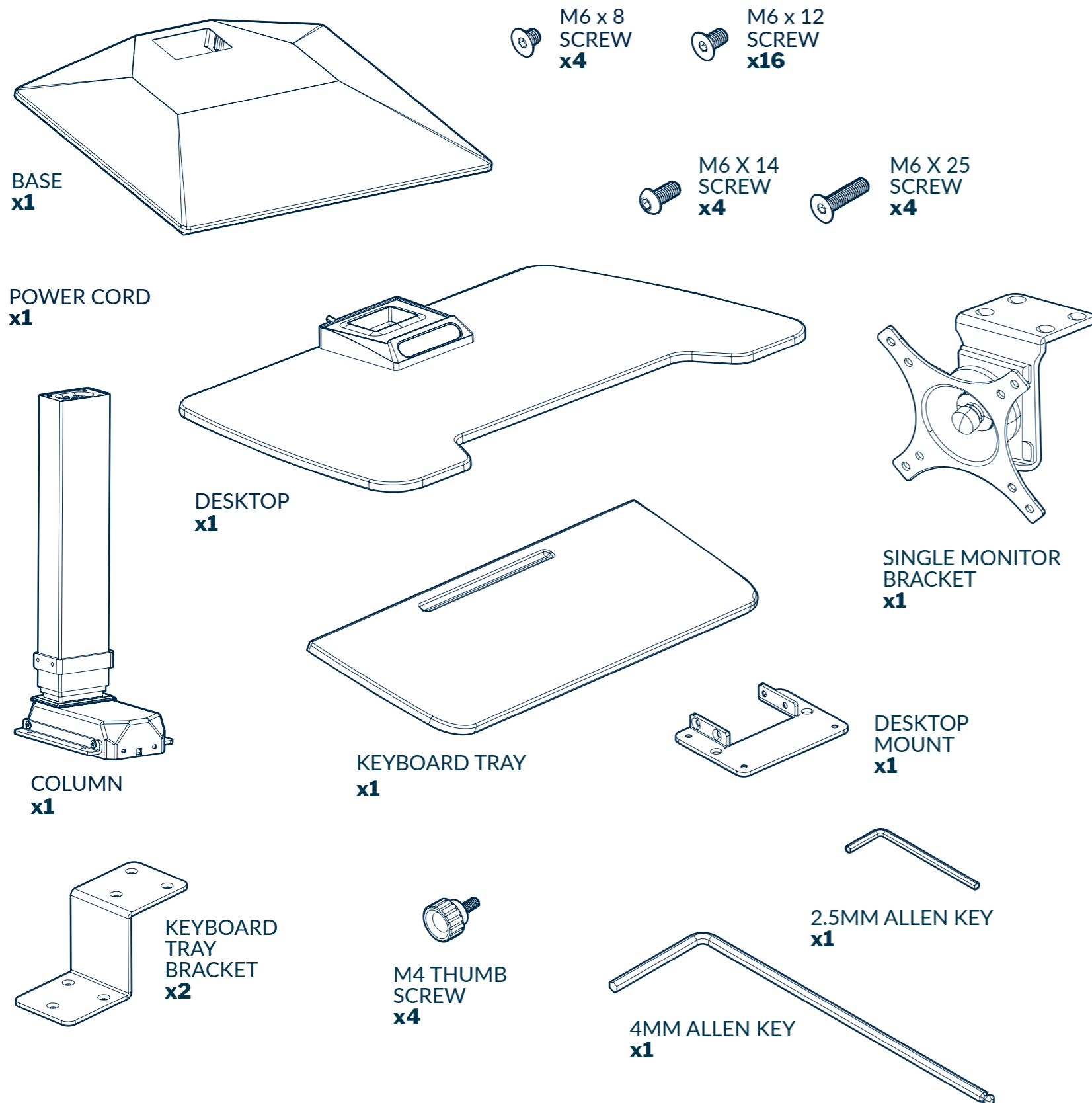

NOTE: If you purchased the VariDesk®Premier Electric Dual-Monitor, the Dual-Monitor Mounting Bracket and components below will ship and arrive in a separate box.

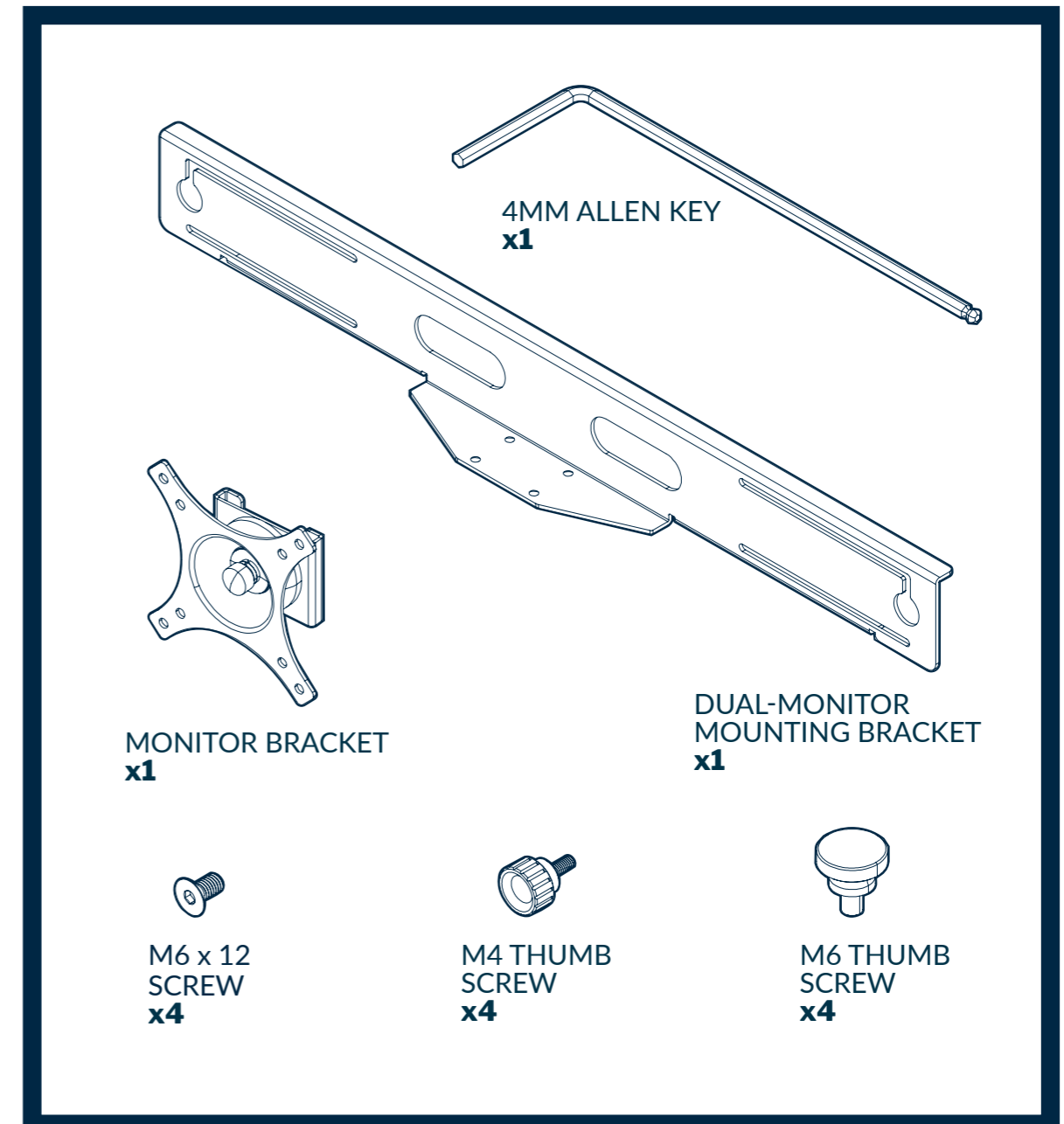

Weight Capacities

Desktop = 55 lbs (25 kg)
Keyboard Tray = 11 lbs (5 kg)
Single-Monitor = 20 lbs (9 kg)

Max Monitor Screen Size = 24"
Dual-Monitor = 20 lbs (9 kg)
 per Monitor Mount

1

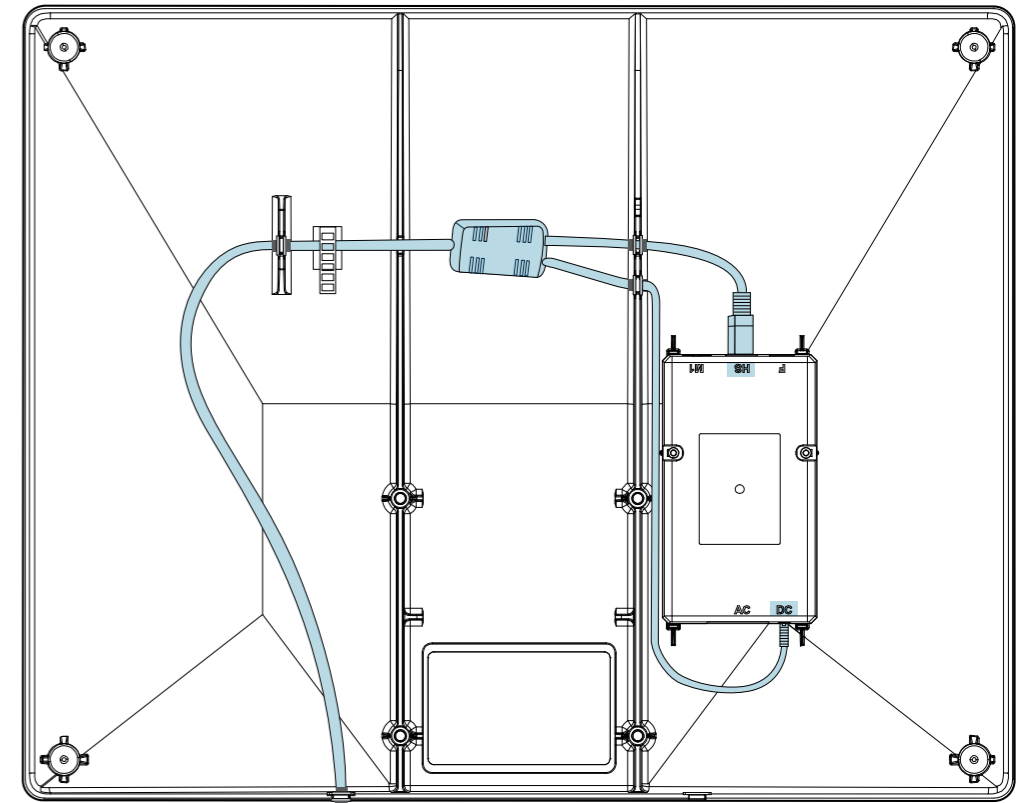
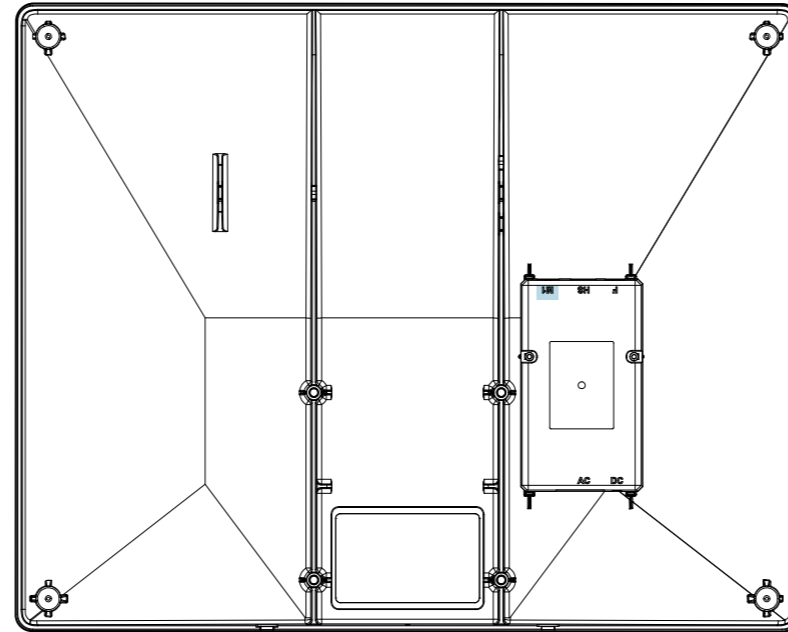
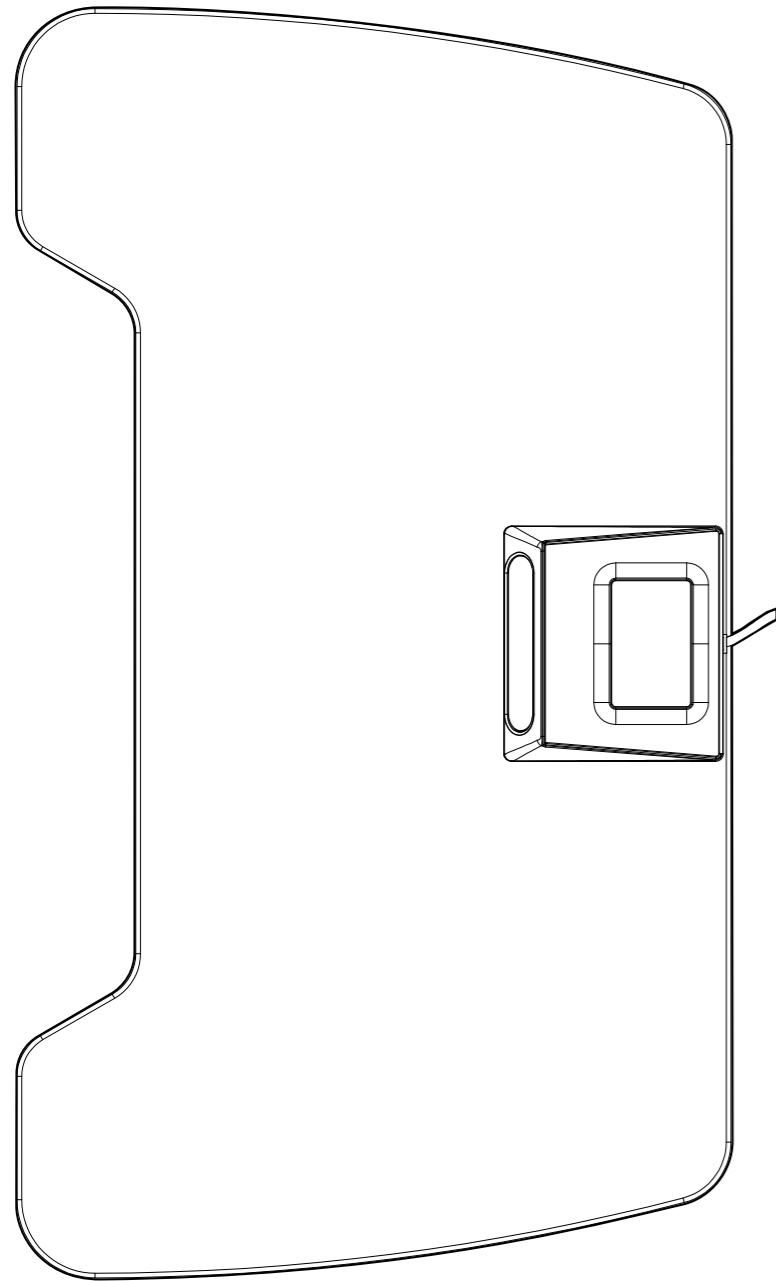

*Note: We recommend assembling the desktop converter on a smooth, debris-free, flat surface to prevent scratches.

STEP 1:

1. Remove all items from the box.
2. Place the **BASE** and **DESKTOP** side by side, and then flip the **BASE** over to access the control box and cords.
3. Route the **CABLES** through the cable channels underneath the **BASE**.
4. Connect the cables to the **HS** and **DC** ports on the **CONTROL BOX**.

2

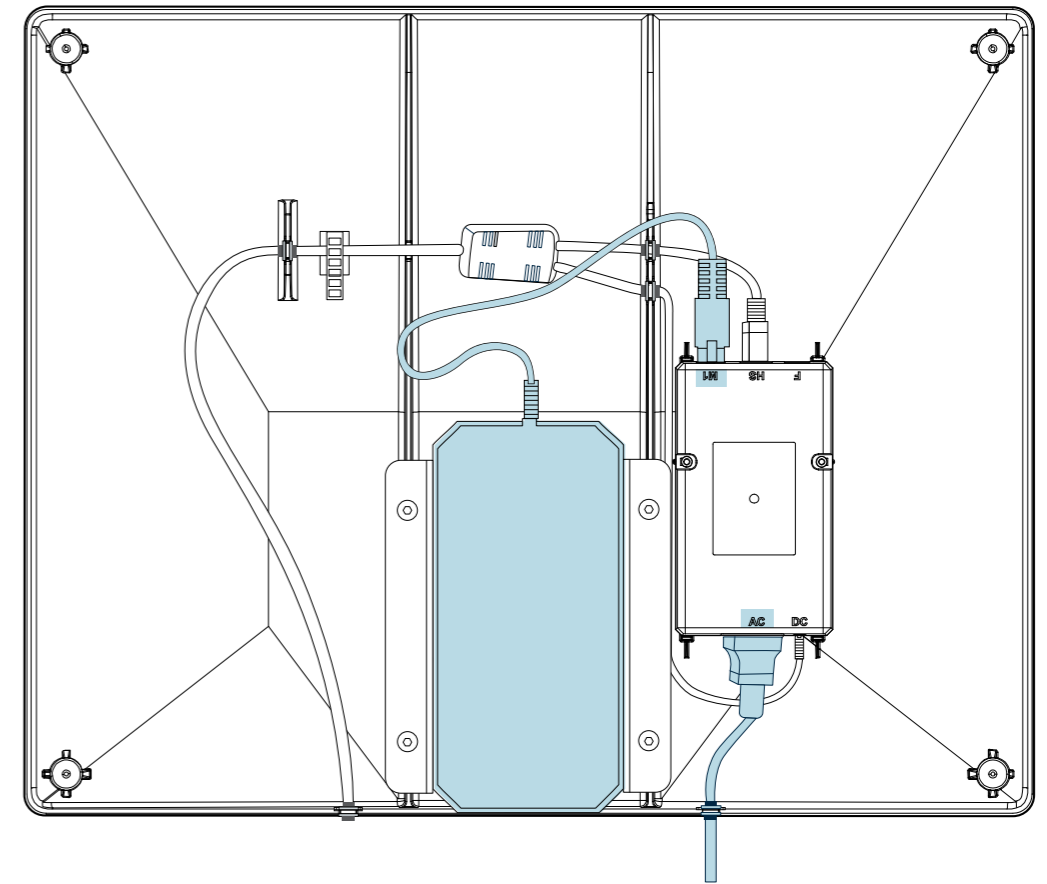
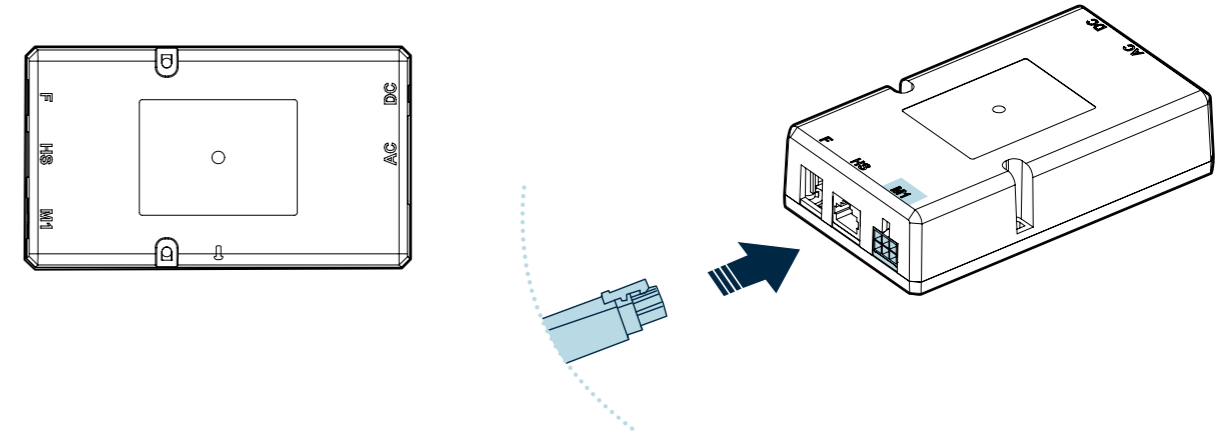
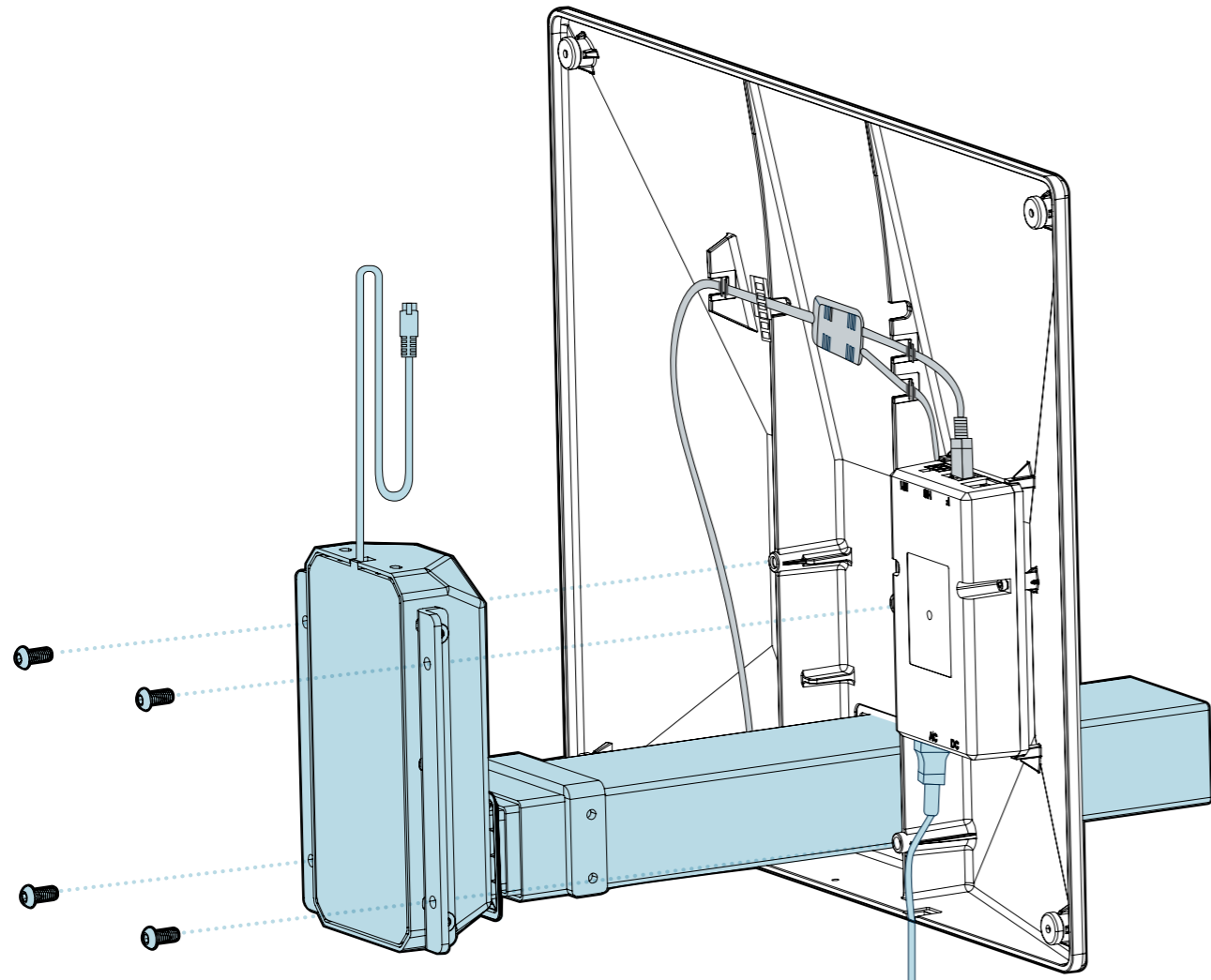

STEP 2:

1. Insert the **COLUMN** into the **BASE**.
2. Insert (4) **M6 x 14 SCREWS** into the screw holes.
3. Secure them using the provided **4MM ALLEN KEY**.
4. Connect the **COLUMN CABLE** to the **M1 PORT** of the **CONTROL BOX**.
5. Route the **POWER CORD** through the groove at the rear of the **BASE** and connect it to the **AC PORT** on the **CONTROL BOX**.

3

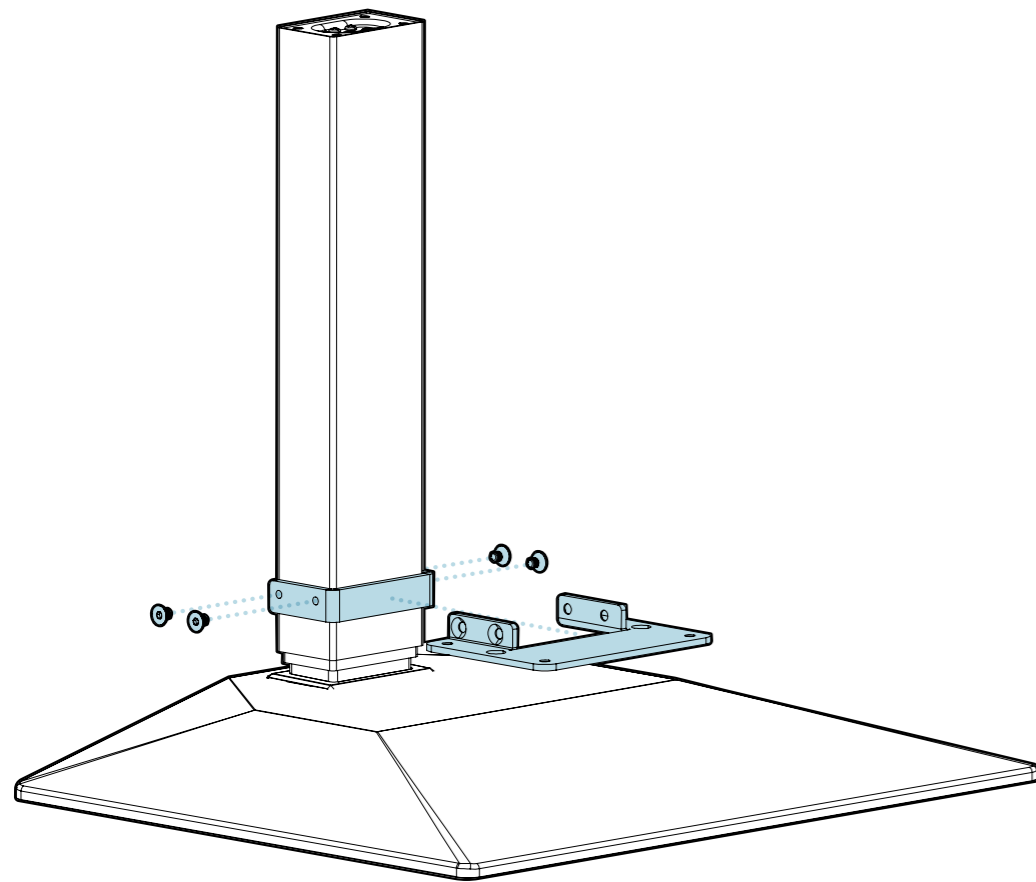

STEP 3:

1. Flip the assembled **BASE** upright.
2. Align the **DESKTOP MOUNT** with the **COLUMN** screw holes.
3. Insert (4) **M6 x 8 SCREWS** into the **COLUMN**.
4. Secure them with the provided **4MM ALLEN KEY**.

4

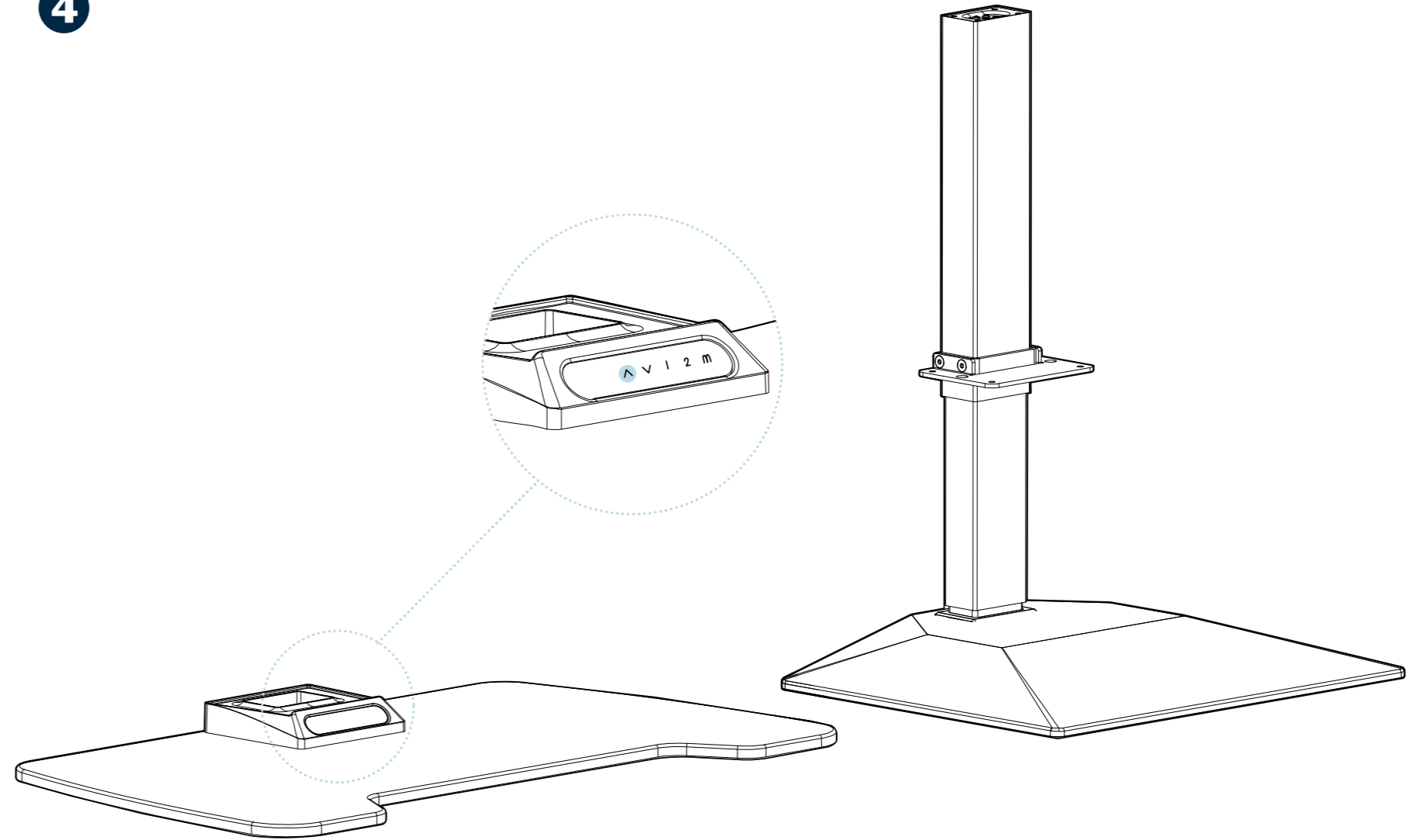

STEP 4:

1. Plug the converter in.
2. Press the UP button on the Control Panel to raise the **COLUMN** to the desired height for installing the **DESKTOP**.

5

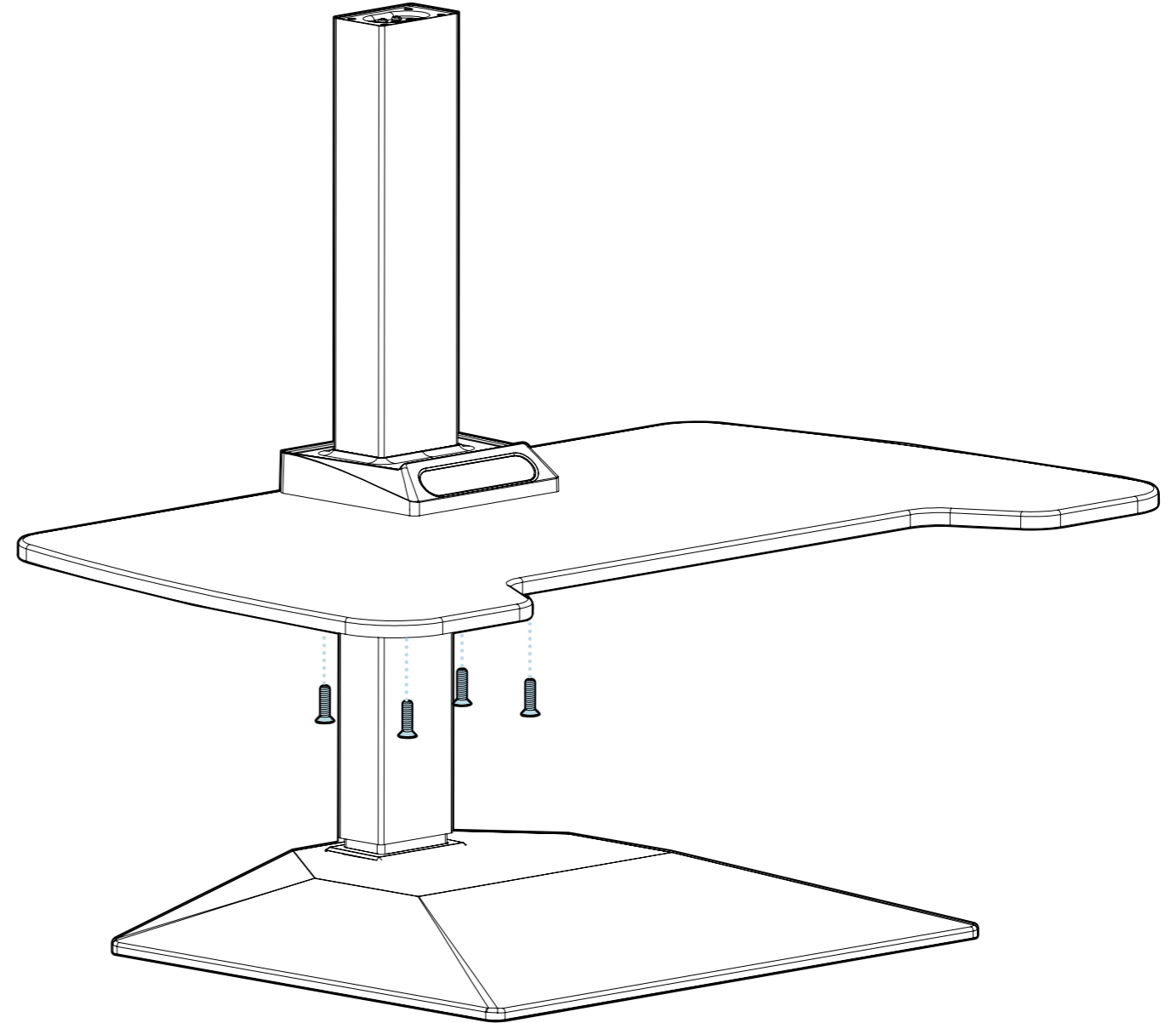
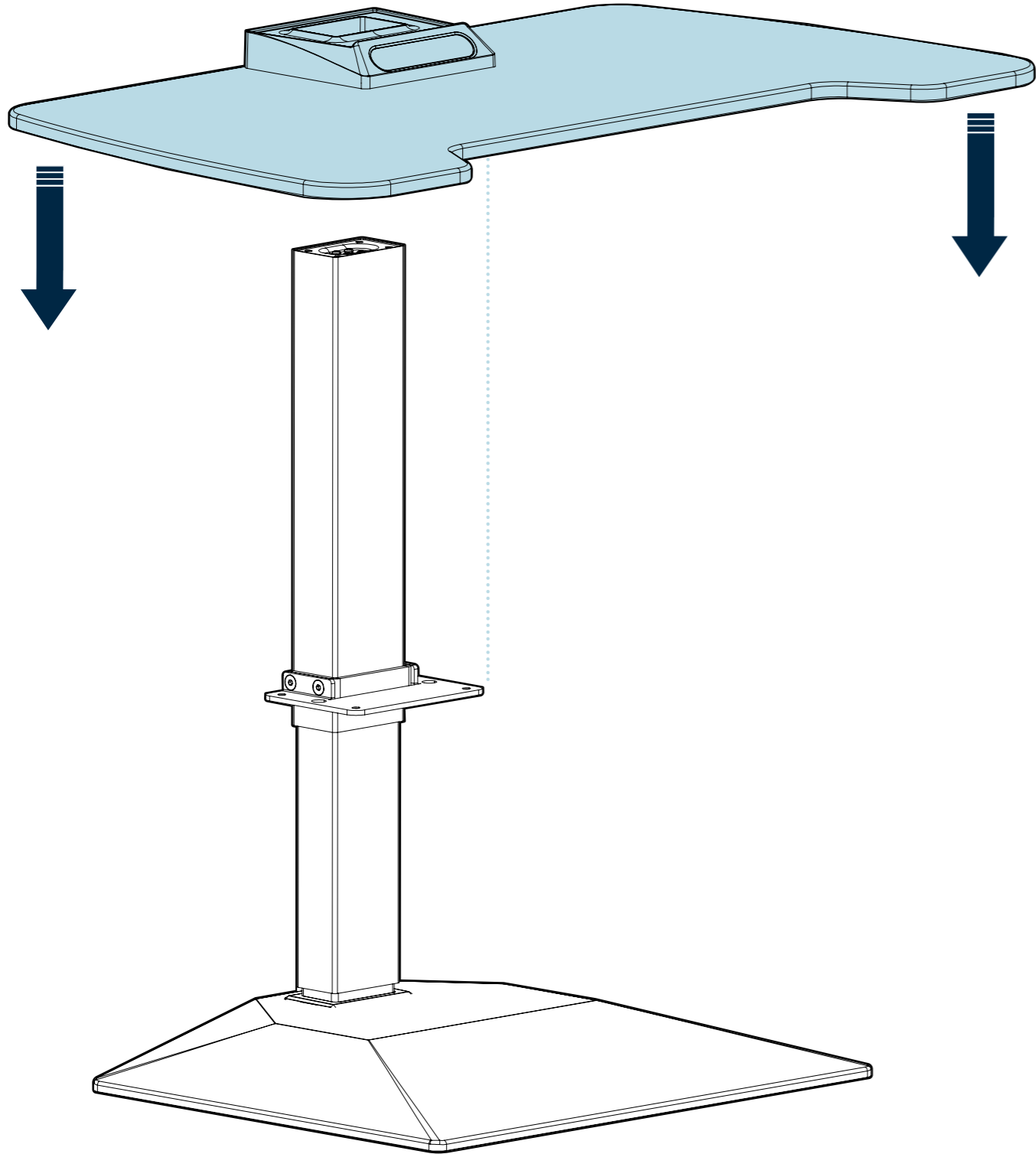

STEP 5:

1. Carefully place the **DESKTOP** onto the **COLUMN** until it contacts the **DESKTOP MOUNT**.
2. Insert (4) **M6 x 25 SCREWS** into the **DESKTOP MOUNT**.
3. Secure the **DESKTOP** in place with the **4MM ALLEN KEY**.

6

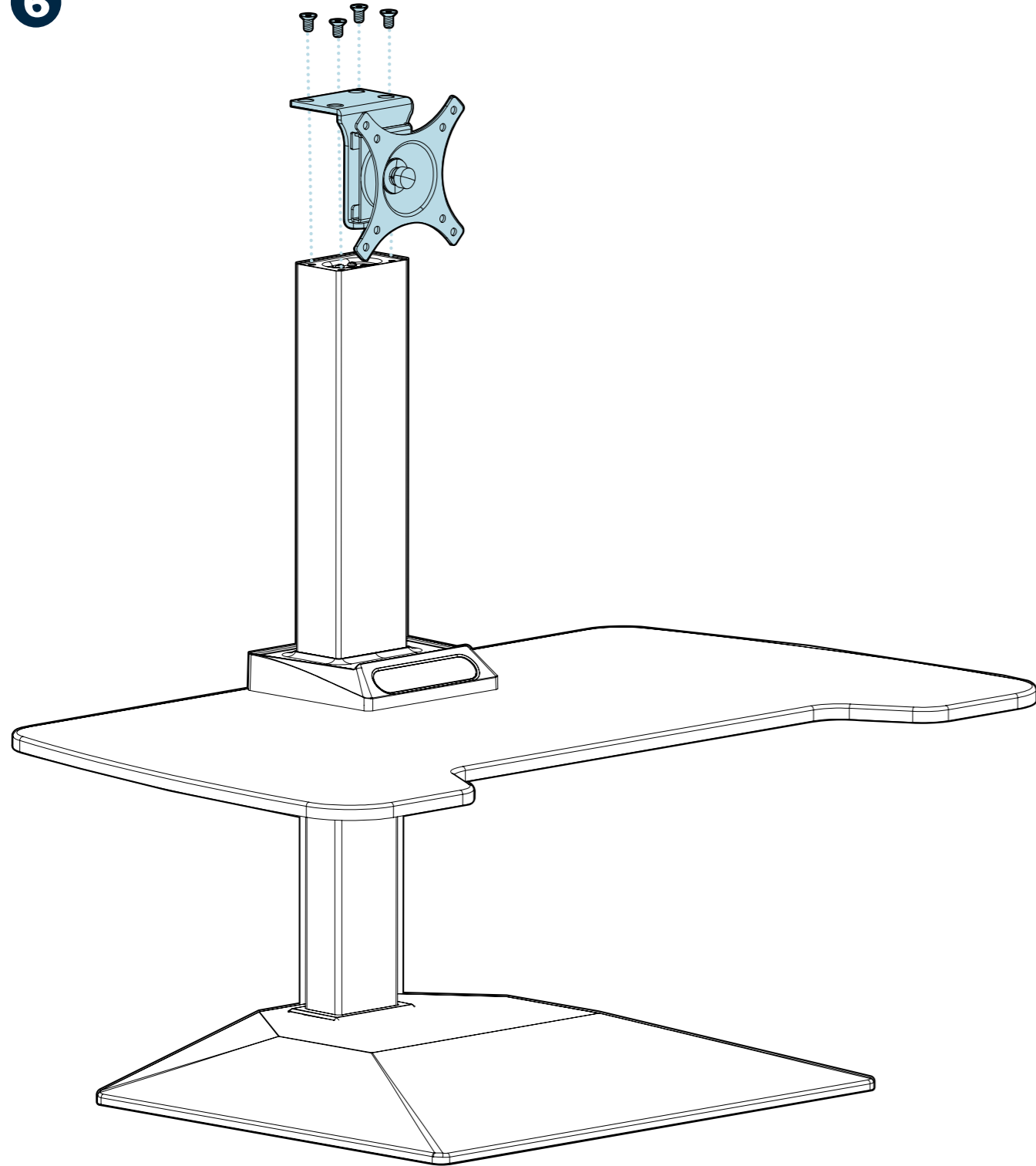

STEP 6:

1. Place the **SINGLE MONITOR BRACKET** on top of the **COLUMN** and align the screw holes.
2. Insert (4) **M6 x 12 SCREWS** into the **BRACKET**.
3. Secure it to the **COLUMN** using the **4MM ALLEN KEY**.

Note: If you purchased the VariDesk® Premier Electric Dual-Monitor, follow the steps below to install the Dual-Monitor Mounting Bracket.

6a

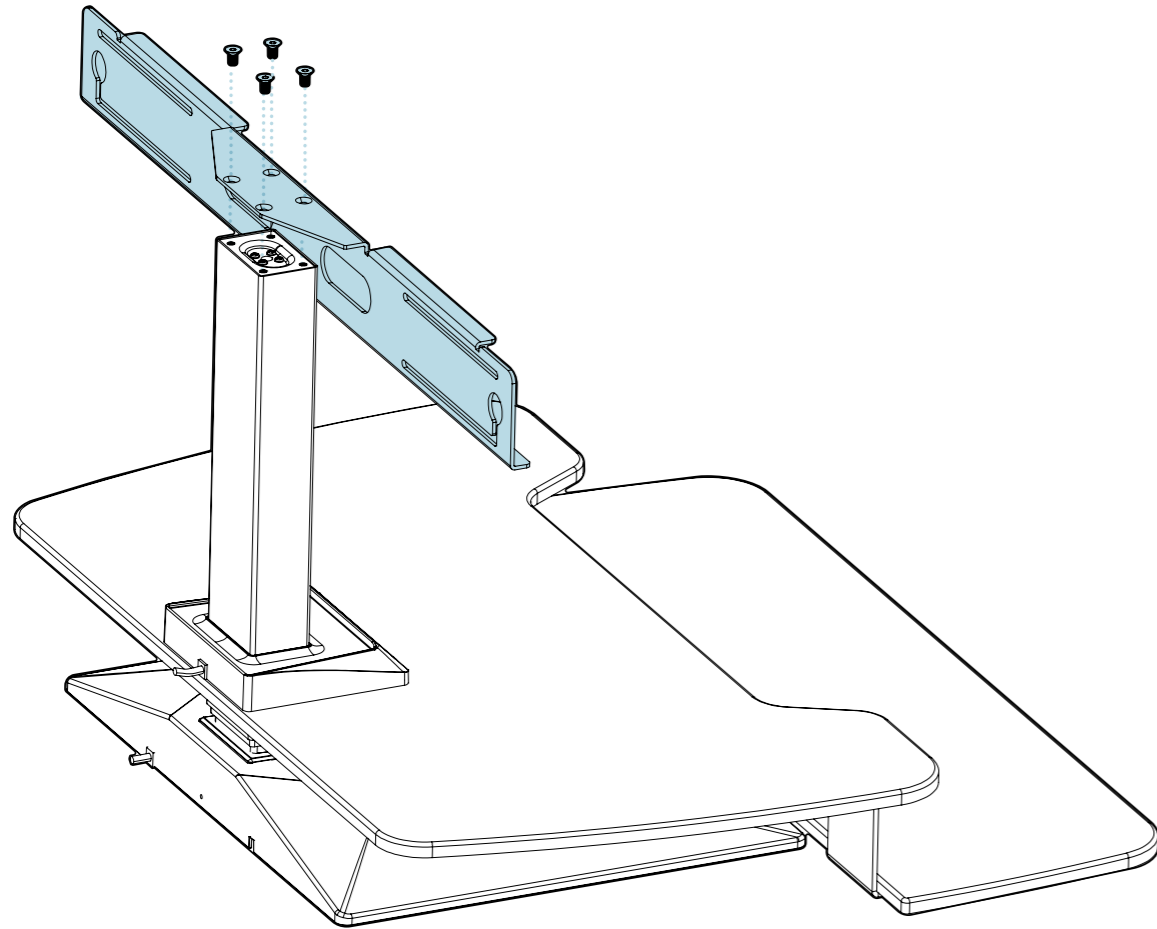

STEP 6a:

1. Place the **DUAL-MONITOR MOUNTING BRACKET** on top of the **COLUMN** and align the screw holes.
2. Insert (4) **M6 x 12 SCREWS** into the **BRACKET**.
3. Secure it to the **COLUMN** using the **4MM ALLEN KEY**.

6b

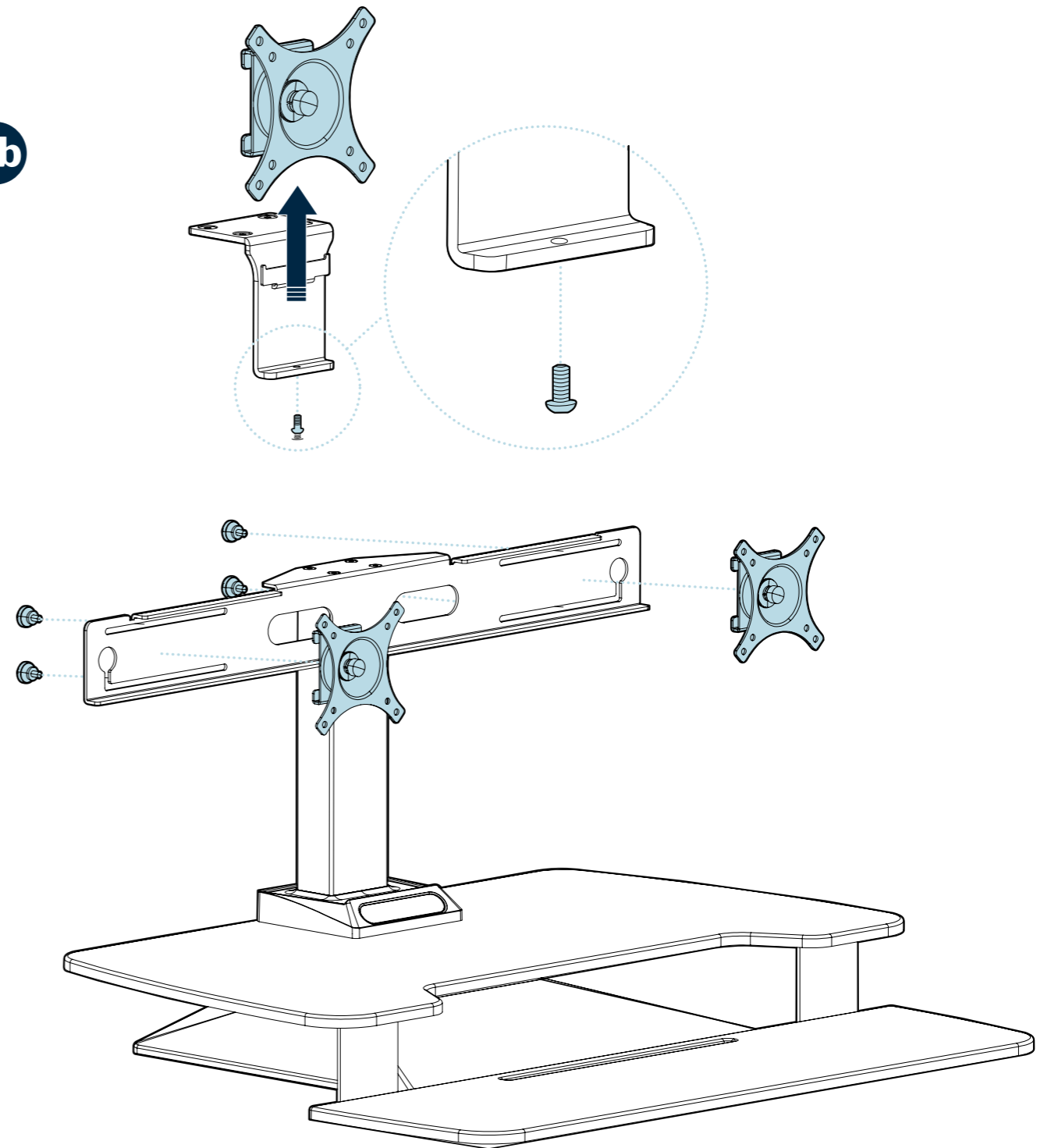

Note: One of the MONITOR BRACKETS will need to be removed from the SINGLE-MONITOR MOUNTING BRACKET and added to the DUAL-MONITOR MOUNTING BRACKET.

STEP 6b:

1. Align the (2) **MONITOR BRACKETS** with the upper and lower slots of the **DUAL-MONITOR MOUNTING BRACKET**.
2. Insert (2) **M6 THUMB SCREWS** into each **MONITOR BRACKET** to secure them in place.

7

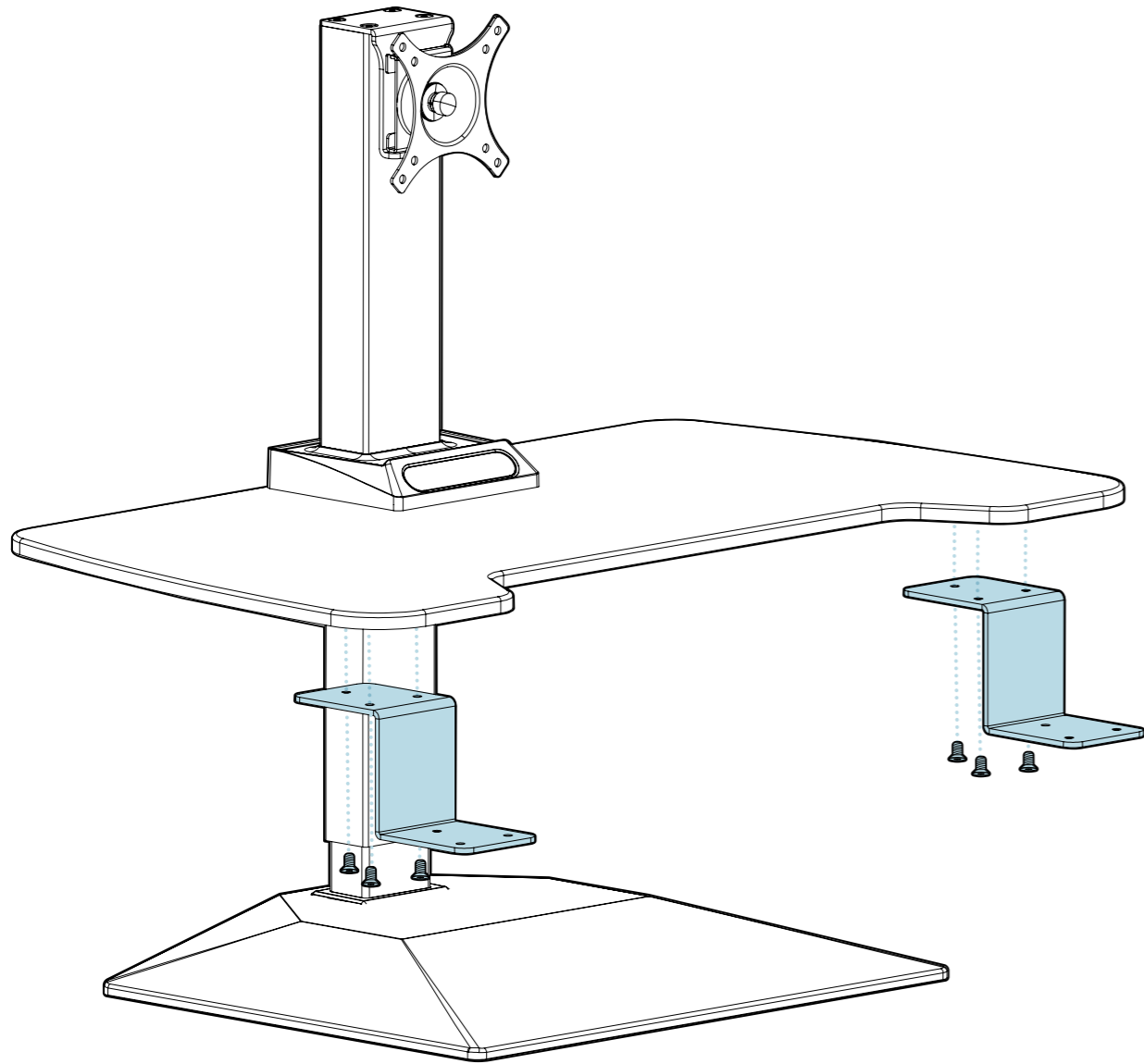

STEP 7:

1. Align the **KEYBOARD TRAY BRACKETS** with the screw holes underneath the **DESKTOP**.
2. Insert (3) **M6 x 12 SCREWS** into each **BRACKET**, for a total of (6).
3. Secure them to the **DESKTOP** using the provided **4MM ALLEN KEY**.

8

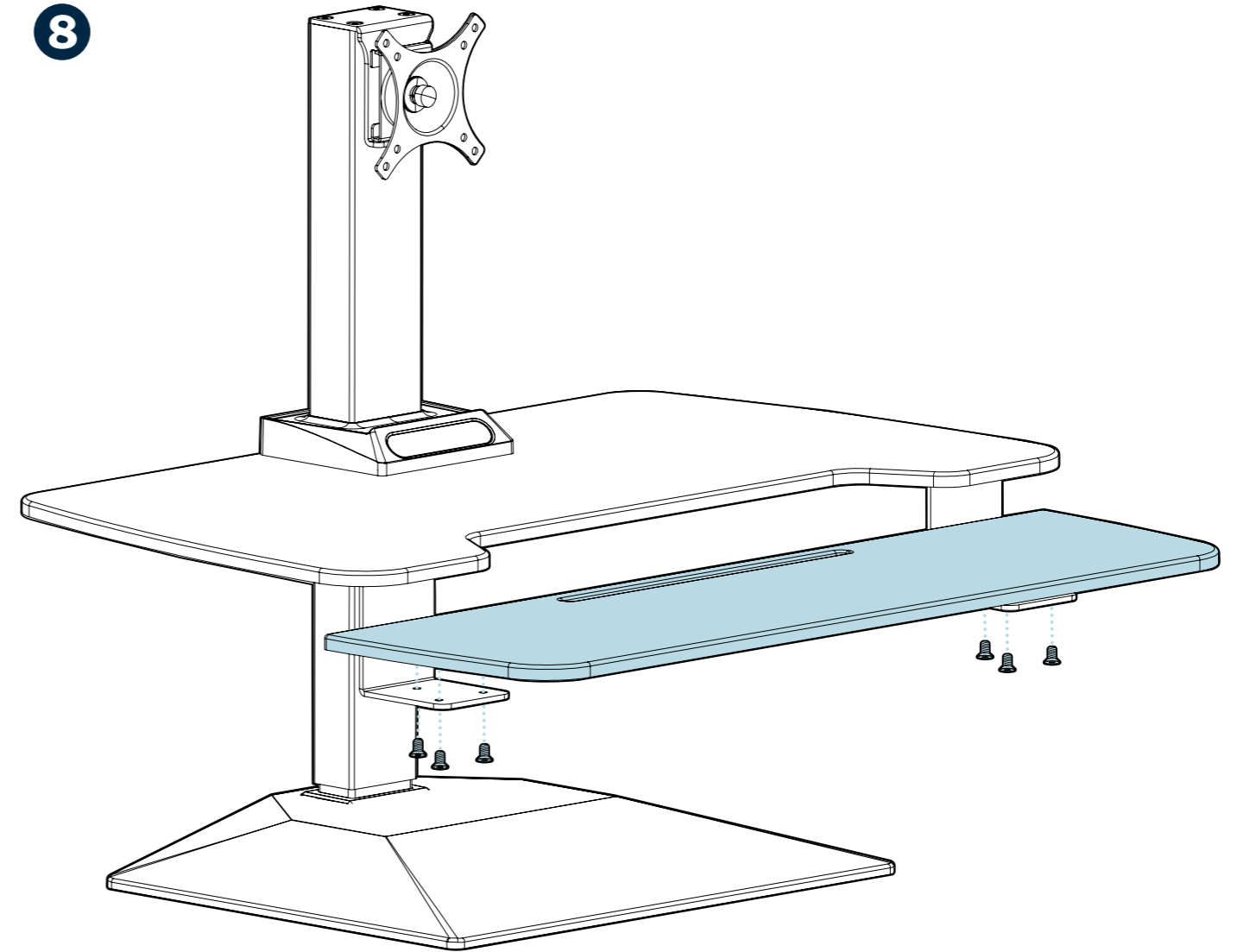

STEP 8:

1. Place the **KEYBOARD TRAY** on top of the **KEYBOARD TRAY BRACKETS** and align the screw holes.
2. Insert (3) **M6 x 12 SCREWS** into each **BRACKET**, for a total of (6).
3. Secure the **KEYBOARD TRAY** in place using the provided **4MM ALLEN KEY**.

The VariDesk® Premier Electric Single-Monitor and Dual-Monitor feature integrated **USB-A** and **USB-C** ports for charging your devices.

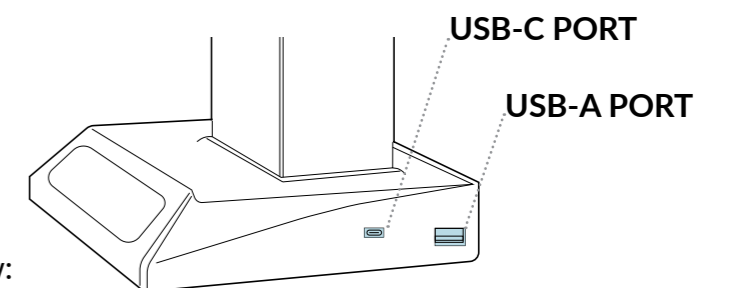

Please see the power output details below:

USB-A + USB-C Simultaneous Working Output: 5V = 3A Shared (Max 18W)

USB-A Separate Output: 5V = 3A, 9V = 2A, 12V = 1.5A (Max 18W)

USB-C Separate Output: 5V = 3A, 9V = 2A, 12V = 1.5A (Max 18W)

Product Setup & Adjustments

Initial Setup:

1. Press the **DOWN** button on the Control Panel until the base reaches its lowest position.
2. Press and hold the **DOWN** button again until the LED display reads **"RST"**.
3. Press and hold the 1 button (about 5 seconds) while the LED flashes **"RST"** and switches to either:
 - 10.1 = One-Touch (preset buttons work with one quick press)
 - 10.2 = Constant-Touch (preset buttons work when pressed and held down for a few seconds)
4. Release the 1 button.
5. Press the 1 button again until the desired setting is reached.
6. Once the chosen setting is displayed, release the button and wait for the display to return to **"RST"**.
7. Finish the reset process by pressing and holding the **DOWN** button until the desktop lowers a little bit more, slightly rises, and stops.
8. Release the button. The new program is saved, and your desk is now ready to use.

Inches to Centimeters

To toggle from inches to centimeters on the display, first press the **DOWN** button until the desk reaches the lowest position (4.3"). Press and hold the **DOWN** button again until the display flashes **"RST"**. Press and hold the 2 button (about

8 seconds) until the display flashes **"RST"** and then switches to either 10.3 (= cm) or 10.4 (= in).

If the display is not flashing **"RST"**:

1. Lower the desk to the lowest position (4.3"), then release the button.
2. Press and hold the **DOWN** button until the **"RST"** flashes and release the button.
3. Press and hold the **DOWN** button again until the display shows the height of 11.0", then release the button.

If the display is already flashing **"RST"**, begin with step 2 above.

Height Settings and Preferences

The height settings range from 4.3"-21.6". You can program 2 height preferences by raising or lowering the desk to your desired height, pressing the **"M"** button (you will see **"S-"** appear on the display), then pressing 1 or 2.

Setting Upper & Lower Limits

The height settings range from 4.3"-21.6". If you prefer to change the settings to a more narrow range, follow the below steps.

Make sure the power is ON and a number reads on the LED display (if no number appears, please follow the Troubleshooting and Reset procedure).

To set the Upper-Limit Position: Use the UP/DOWN buttons to move the base to the desired maximum-height position. Press the **"M"** button and release. Press the UP button and release. The LED display will flash **"S-"**. Press and hold the **"M"** button until the LED display changes to **"999"**. The display will automatically return to the selected height. The new upper limit is now set.

To set the Lower-Limit Position: Use the UP/DOWN buttons to move the base to the desired minimum-height position. Press the **"M"** button and release. Press the DOWN button and release. The LED display will flash **"S-"**. Press and hold the **"M"** button until the LED display changes to **"000"**. The display will automatically return to the selected height. The new lower limit is now set.

To Remove Upper/Lower Limit Positions: Press the **"M"** button and release. The LED display will read **"S-"**. Within 5 seconds, press and hold the **"M"** button again for 2 seconds. The LED display will change to **"555"** and then automatically return to the height display. The upper and lower limits are now removed.

WARNING: A RESET procedure requires the desk base to fully retract (beyond any lower limit set). Please ensure that you have the proper clearance below the desk base. After the upper and lower limits are set, the previous memory positions (1, 2) may be outside the new range of movement.

If so, simply reset the memory positions. If you attempt to revise a previously set upper or lower limit and it is outside of the existing range, you will need to remove the previously set upper/lower limits first.



WARNING: Do not open any of the components, there is a danger of electric shock.



WARNING: Keep plug away from heated surfaces.



WARNING: Never operate this product if it has a damaged cord or plug, is not working properly, has been dropped or damaged, or was dropped into water. Contact our customer service department during business hours to report any issues.



WARNING: VariDesk® Premier Electric is not intended for use by young children or for those persons who require supervision.



WARNING: To reduce risk of fire, electric shock, or personal injury, use only indoors and do not install in a wet or damp location.



CAUTION: Beverages such as water or coffee could cause product failure if spilled.



WARNING: Risk of finger injury - pinching hazard. Use caution when lowering desk.

Supplier's Declaration of Conformity 47 CFR § 2.1077 Compliance Information

Unique Identifier: 402614, 402617, 402616, 402615

Responsible Party - U.S. Contact Information

Varidesk, LLC
450 Freeport Parkway
Coppell, TX 75019
1-800-207-2587

FCC Compliance Statement

This device complies with Part 15 of the FCC Rules. Operation is subject to the following two conditions: (1) This device may not cause harmful interference, and (2) this device must accept any interference received, including interference that may cause undesired operation.

CODE	DESCRIPTION	TROUBLESHOOTING SOLUTION
E01	Over Current Protection	Over current protection feature triggered, over current always caused by over loading. Remove items or reduce weight from concentrated area (rated loading is average distribution). Follow the reset instruction to reset the system. If error persists, contact Vari.
E07	Hall Error	E07 will display if the cable connected to the M1 port is not fully secured. Disconnect and reconnect the cable. Follow below instructions to reset (RST) the desk. If the error persists, contact Vari.
H01	Over Duty Protection	If the desk is raised and lowered continuously for more than 2 minutes, it will display this code and cease working temporarily to protect the mechanism from overheating. Stop adjusting the desk, and resume after 20 minutes.
RST	System Reset	<p>If the display is showing an ERROR CODE: Make sure all cables are securely connected. Press and hold the down button (about 5 seconds) on the control panel until RST flashes on the screen. Release the down button, and continue with the steps below.</p> <p>If the display is already flashing "RST": Press and hold the down button until the desk reaches the lowest height, raise slightly, and finally displaying height number. Do not release the down button until height number is shown on the control panel. The desk is now ready to use.</p>